

MeetUp/Webcam Ceiling/Wall Mount

TM-TELE_WC EU SAP: 5900231

vav.link/tm-tele_wc

Adaptor that fixes [Logitech MeetUp](#) to any of Vision's projector ceiling mounts
Also fits any webcam to the same mounts
Uses standard tripod mount screw



This adaptor allows Logitech's MeetUp to attach to all of Vision's projector mounts. Some teaching applications call for MeetUp conference systems to be ceiling-mounted in classrooms.

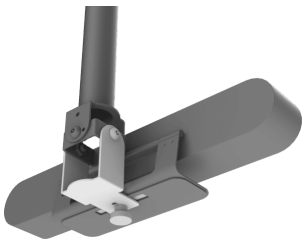

Attaches to...

Any of Vision's projector ceiling brackets: [TM-TELE](#) or [TM-1200](#). Or Vision's [TM-ST2](#) wall boom.

Ready for MeetUp

The Meetup bracket is secured to the adaptor. The unique features of the MeetUp means teachers can teach students in a classroom and remote students at the same time.

Works for all Webcams

Fits [Logitech Brio](#) webcam for [Microsoft Whiteboard](#), or [Huddly](#) cameras, or indeed any webcam with a camera tripod fitting.

Easy fit

The webcam fixes using the standard 1/4-20 UNC tripod screw which is included.

Cable Management

Just drop the cables down through the pole to terminate to the camera for a professional look. Cables are out of sight.

Camera Tilt

The bottom bracket is adjustable so you can direct the camera where you need to.

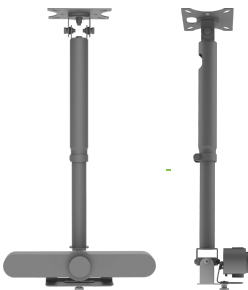

VISION

SOFTWARE

Andriod 1.2.26

PDF 167.38 KB

files.visionaudiovisual.com/products/TM-TELE_WC/manuals/TM-TELE_WC_manual.pdf

IMAGE

WC

ZIP 2.17 MB

files.visionaudiovisual.com/products/TM-TELE_WC/images/TM-TELE_WC.zip

SPECIFICATIONS

BOX DIMENSIONS

x x mm / " x " x "

PACKAGED WEIGHT

kg / lbs

SAFE WORKING LOAD

10kg / 22.05 lbs

COLOUR

Satin White

ACCESSORIES INCLUDED

1 x 1/4-20 UNC Screw, 9 mm long 1 x M6 12mm Screw

WARRANTY

Lifetime return-to-base

COMPLIANCES

n/a

ORDER PART CODE

TM-TELE_WC [EU SAP: 5900231 / US SAP: tba]



VISION